

## ROCKET 2.4: 2.4GHz Hi Power 2x2 MIMO AirMax TDMA BaseStation

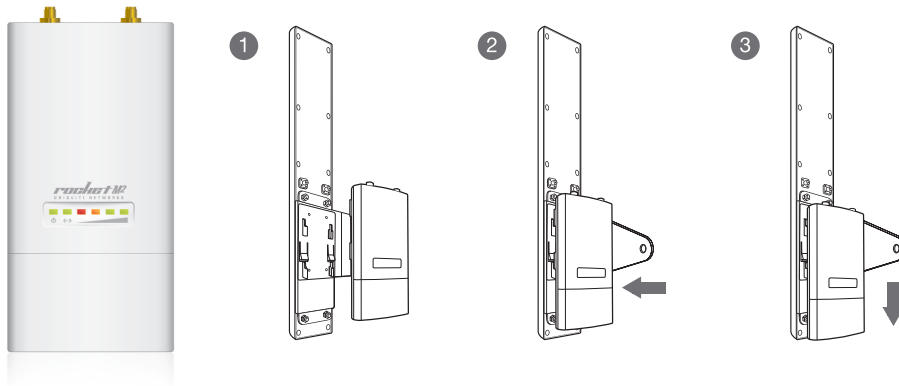

**airMAX**  
MIMO TDMA Protocol

### COMPATIBLE ANTENNAS

AirMax Sector 2G-16-90  
AirMax Sector 2G-15-120  
Rocket Dish 2G-26

### SYSTEM INFORMATION

Processor Specs	Atheros MIPS 24KC, 400MHZ
Memory Information	32MB SDRAM, 8MB Flash
Networking Interface	2 X 10/100 BASE-TX (Cat. 5, RJ-45) Ethernet Interface

### REGULATORY / COMPLIANCE INFORMATION

Wireless Approvals	FCC Part 15.247, IC RS210, CE
RoHS Compliance	YES

### OPERATING FREQUENCY 2412MHz-2462MHz

TX POWER SPECIFICATIONS				RX SPECIFICATIONS			
	DataRate	Avg. TX	Tolerance		DataRate	Sensitivity	Tolerance
<b>11b/g</b>	1-24Mbps	28 dBm	+/-2dB	<b>11b/g</b>	1-24Mbps	-97 dBm min	+/-2dB
	36Mbps	26 dBm	+/-2dB		36Mbps	-80 dBm	+/-2dB
	48Mbps	25 dBm	+/-2dB		48Mbps	-77 dBm	+/-2dB
	54Mbps	24 dBm	+/-2dB		54Mbps	-75 dBm	+/-2dB
<b>11n / Airmax</b>	MCS0	28 dBm	+/-2dB	<b>11n / Airmax</b>	MCS0	-96 dBm	+/-2dB
	MCS1	28 dBm	+/-2dB		MCS1	-95 dBm	+/-2dB
	MCS2	28 dBm	+/-2dB		MCS2	-92 dBm	+/-2dB
	MCS3	28 dBm	+/-2dB		MCS3	-90 dBm	+/-2dB
	MCS4	27 dBm	+/-2dB		MCS4	-86 dBm	+/-2dB
	MCS5	25 dBm	+/-2dB		MCS5	-83 dBm	+/-2dB
	MCS6	23 dBm	+/-2dB		MCS6	-77 dBm	+/-2dB
	MCS7	22 dBm	+/-2dB		MCS7	-74 dBm	+/-2dB
	MCS8	28 dBm	+/-2dB		MCS8	-95 dBm	+/-2dB
	MCS9	28 dBm	+/-2dB		MCS9	-93 dBm	+/-2dB
	MCS10	28 dBm	+/-2dB		MCS10	-90 dBm	+/-2dB
	MCS11	28 dBm	+/-2dB		MCS11	-87 dBm	+/-2dB
	MCS12	27 dBm	+/-2dB		MCS12	-84 dBm	+/-2dB
	MCS13	25 dBm	+/-2dB		MCS13	-79 dBm	+/-2dB
	MCS14	23 dBm	+/-2dB		MCS14	-78 dBm	+/-2dB
MCS15	22 dBm	+/-2dB	MCS15	-75 dBm	+/-2dB		

### PHYSICAL / ELECTRICAL / ENVIRONMENTAL

Enclosure Size	16cm length x 8cm width x 3cm height
Weight	0.5 kg
RF Connector	2x RPSMA (Waterproof)
Enclosure Characteristics	Outdoor UV Stabilized Plastic
Mounting Kit	Pole Mounting Kit included
Max Power Consumption	6.5 Watts
Power Supply	24V, 1A POE Supply Included
Power Method	Passive Power over Ethernet (pairs 4,5+; 7,8 return)
Operating Temperature	-30C to 75C
Operating Humidity	5 to 95% Condensing
Shock and Vibration	ETSI300-019-1.4